

oeil/émérillon

croc/émérillon

oeil à maniller/émérillon

chape/émérillon

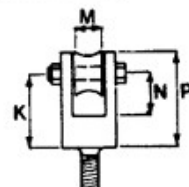
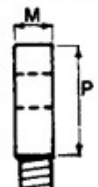
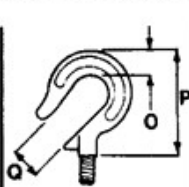
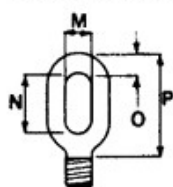

REFERENCE

M N O P O P Q L M R P K L M N R P

	mm	mm	mm	mm	mm	mm	mm	mm	mm	mm	mm	mm	mm	mm	mm	mm	mm
KT 1	25	34	13	65	20	82	25										
KT 2	23	57	16	94	25	94	28										
KT 3	26	66	20	110	30	105	30										
KT 4	33	82	24	134	38	132	38	26	35	35	93	104	23	40	65	30	134
KT 6	40	95	28	153	46	170	46	29	42	40	100	104	23	40	65	30	134

roulement à billes

baque en bronze

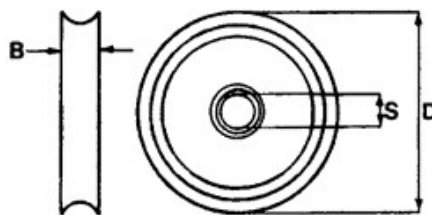
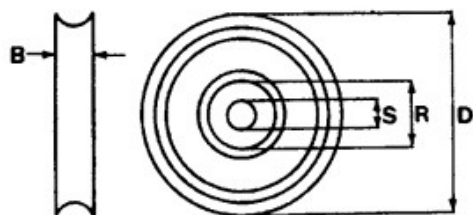

REFERENCE	B	D	R	S	POIDS
	mm	mm	mm	mm	kg
SKT 1-1	22	80	40	17	0,60
SKT 2-1	24	110	52	20	1,25
SKT 3-1	28	150	47	20	2,65
SKT 4-1	35	185	62	30	5,10
SKT 6-1	42	210	76	30	7,70

REFERENCE	B	D	S	POIDS
	mm	mm	mm	kg
SKT 1-0	22	80	20	0,75
SKT 2-0	24	110	25	1,30
SKT 3-0	28	150	25	2,60
SKT 4-0	35	185	30	5,20
SKT 6-0	42	210	30	7,60

roulement à billes

baque en bronze

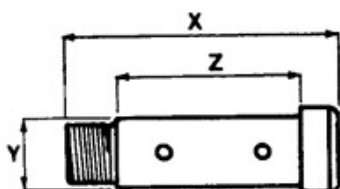

REFERENCE	X	Y	Z	POIDS
	mm	mm	mm	kg
PKT 1T-1	50	17	28	0,10
PKT 2T-1	52	20	30	0,15
PKT 3T-1	67	20	41	0,20
PKT 4T-1	75	30	43	0,40
PKT 6T-1	85	30	51	0,45

REFERENCE	X	Y	Z	POIDS
	mm	mm	mm	kg
PKT 1T-0	57	20	28	0,10
PKT 2T-0	61	25	30	0,15
PKT 3T-0	67	25	35	0,20
PKT 4T-0	75	30	43	0,40
PKT 6T-0	85	30	51	0,45